

REVISIONS

ZONE	REV	DESCRIPTION	DATE	APPROVED
	A	A-JAN-14 12458JPL-C5E	JAN'14	

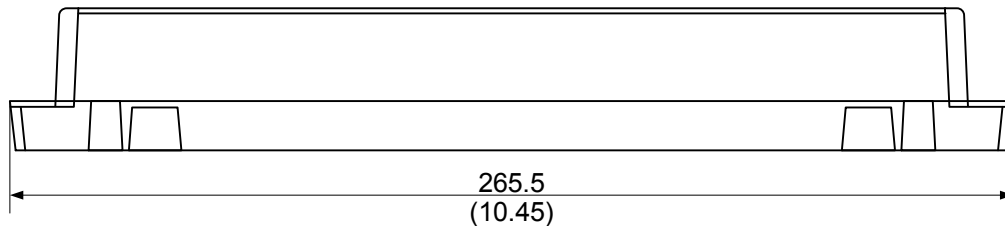
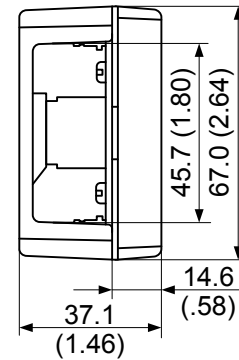
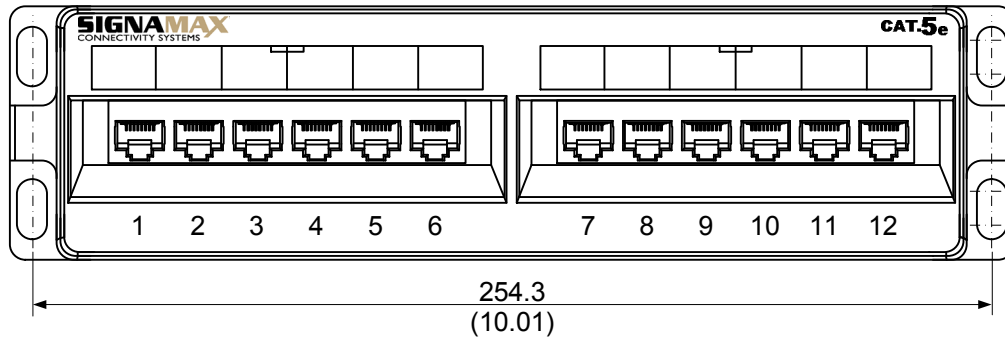
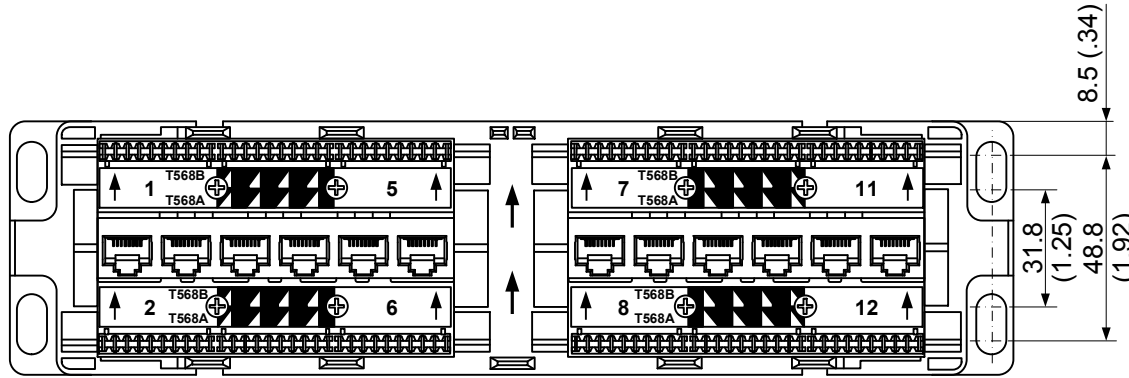

NOTES:

TRANSMISSION PERFORMANCE:

- ANSI/TIA-568-C.2, category 5e

ENVIRONMENTAL:

- Storage temperature: -40 °C-+70 °C (-40 °F-+158 °F)
- Operation temperature: -10 °C-+60 °C (+14 °F-+140 °F)
- RH (operation): max non-condensing 93 %

ELECTRICAL:

- Insulation resistance: min 500 MOhm @ 100 V_{dc}
- Dielectric withstanding voltage: 1000 V_{dc/ac} peak contact-to-contact @ 60 Hz for 1 min
1500 V_{dc/ac} peak contact-to-panel @ 60 Hz for 1 min
- Spring wire contact resistance: max 20 mOhm
- IDC contact resistance: max 2.5 mOhm

MECHANICAL:

- Retention: 50 N (11 lbf) for 60 ± 5 s
- Mating cycle life: min 750 cycles
- IDC wire gauge: 22-24 AWG (0.644-0.511 mm)

CONSTRUCTION:

- Housing:
 - body: high-impact 94V-0 flame-retardant plastic
 - legs: SAE 1010 1.6 mm (0.063 in), black paint coating
- Jack spring wire: phosphor bronze alloy plated with 50 microinches of gold over 70-100 microinches of nickel
- IDC: 110 type, phosphor bronze alloy with 100 microinches of 100% tin alloy

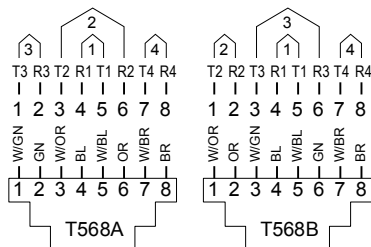

WIRING SCHEMES

UNLESS OTHERWISE SPECIFIED
DIMENSIONS ARE IN MILLIMETERS (INCHES)
TOLERANCES: MM IN ANGULAR

0.0: ±0.2 0.0: ±0.016 0 ±1°
0.00: ±0.1 0.00: ±0.008 0.0 ±0.5°
0.000: ±0.004

MATERIAL: AS NOTES
MECHANICAL: AS NOTES
ELECTRICAL: AS NOTES

PROJECT ID SPCS - PD		FILE SPCS - PD.JPL-12C5E	JAN'14
PROCESS	INITIALS	NAME	DATE
DRAWN			
CHECK			
APPROVED			



999 NW 159 th Drive, Miami, FL 33169, PH: (305) 944-7710, FX: (305) 949-4483, www.signamax.com			
TITLE 12458JPL-C5E (CAT5E 12-PORT SURFACE-MOUNT JACK PANEL)			
SIZE A	CAGE CODE	DWG. NO.	REV A
SCALE 1:2	UNIT MM (IN)	SHEET 1 OF 1	