

Quick Start Guide

C-530 Series 10 Gigabit Managed Switch



1. Unpack the Switch and Check Contents

Part Number	RJ-45 Ports	PoE Ports	SFP+ Ports
SC53010	4		12
SC53020	48	48	4
SC53030	48	48	4
SC53040	48		4
SC53050	24	24	4
SC53060	24		4
SC53070	24		4
SC53080	8	8	2
SC53090	24	24	4

Rack Mounting Kit—two brackets and eight screws

Documentation—*Quick Start Guide* (this document) and *Warranty Card*

Power Cord

Note: Other documentation, including the User Manual can be obtained from www.signamax.com

Warning and Cautionary Messages

Warning: This product does not contain any serviceable user parts.

Warning: Installation and removal of the unit must be carried out by qualified personnel only.

Warning: When connecting this device to a power outlet, connect the field ground lead on the tri-pole power plug to a valid earth ground line to prevent electrical hazards.

Warning: This switch uses lasers to transmit signals over fiber optic cable. The lasers are compliant with the requirements of a Class 1 Laser Product and are inherently eye safe in normal operation. However, you should never

look directly at a transmit port when it is powered on.

Warning: When selecting a fiber SFP device, considering safety, please make sure that it can function at a temperature that is not less than the recommended maximum operational temperature of the product. You must also use an approved Laser Class 1 SFP transceiver.

Caution: Wear an anti-static wrist strap or take other suitable measures to prevent electrostatic discharge when handling this equipment.

Caution: Do not plug a phone jack connector in the RJ-45 port. This may damage this device.

Caution: Use only twisted-pair cables with RJ-45 connectors that conform to FCC standards.

Note: The switch is an indoor device. If it is to be used with outdoor devices such as outdoor IP cameras or outdoor WiFi APs, then users are strongly suggested to install a surge protector or surge suppressor in order to protect the switch.

2. Mount the Switch

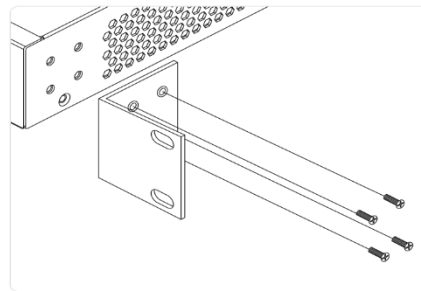

1. Attach the mounting brackets to both sides of the chassis. Insert screws and tighten with a screwdriver to secure the brackets.
2. Place the switch on a rack shelf in the rack. Push it in until the oval holes in the brackets align with the mounting holes in the rack posts.

3. Attach the brackets to the posts. Insert screws and tighten them.



Caution: Installing the switch in a rack requires two people. One person should position the switch in the rack, while the other secures it using the rack screws.

Note: The switch can also be installed on a desktop or shelf using the included adhesive rubber foot.

3. Connect Power

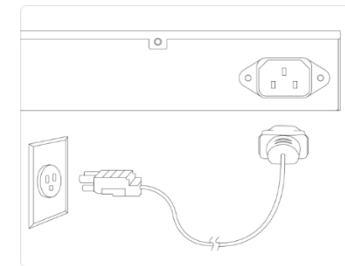

- Plug the AC power cord into the socket on the rear of the switch.
- Connect the other end of the power cord to an AC power source. Verify that the external AC power requirements for the switch can be met as listed below:

100-240 VAC, 50/60 Hz



Note: For International use, you may need to change the AC line cord. You must use a line cord set that has been approved for the socket type in your country.

- Make Sure that the power switch on the back of the switch is in the “ON” position.

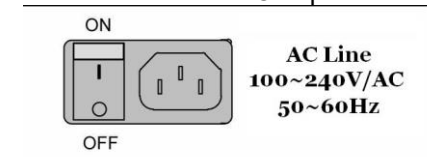

- For models with hot swappable redundant power supplies:
 - Make sure the power supplier are pushed into the bay until they click in
 - Connect both power supplies to an AC source.
 - If one of the power supplies is not connected or not working the switch will beep. The beep can be silenced by pressing the button next to the right power supply.

4. Ground the Switch

- This equipment must be grounded. Never defeat the ground conductor or operate the equipment in the absence of a suitably installed ground conductor. Contact the appropriate electrical inspection authority or an electrician if you are uncertain that suitable grounding is available.



Caution: The device must be installed in a restricted access location.

5. Verify Switch Operation

Verify basic switch operation by checking the system LEDs. When operating normally, the Power LED should be on and green.

6. Connect to the Web User Interface

- Connect a PC to the switch through one of the RJ-45 ports.
- The switch has a default management IP address of 192.168.2.1 and a subnet mask of 255.255.255.0. You must set your PC IP address to be on the same subnet as the switch (that is, the PC and switch addresses must both start with 192.168.2.x).

- Log in to the web interface or CLI using the

default settings: username “admin” and password “admin”.

7. Connect Network Cables

- For RJ-45 ports, connect 100-ohm Category 5e or better twisted-pair cable.
- For the SFP/SFP+ slots, first install SFP/SFP+ transceivers and then connect fiber optic cabling to the transceiver ports. All Signamax 1G and 10G SFPs are supported.
- As connections are made, check the port status LEDs to be sure the links are valid.
 - On/Blinking— Port has a valid link.

Blinking indicates network activity.

8. Connect to the Console Port

- Connect a PC to the switch console port using a RS-232 console cable.
- Configure the PC’s serial port: 115200 bps, 8 characters, no parity, one stop bit, 8 data bits, and no flow control.

9. Reset Button

- The “Reset” button will reset the switch configuration to factory default.
-

- Switch models with no “Reset” button can be factory reset by looping Ports 1 & 2 during boot.
- After resetting the switch back to factory default setting, logon to switch’s Web GUI and save the current settings or use the CLI command “copy running-config startup-config”.

Hardware Specifications

Switch Chassis	
Size (W x H x D)	SC53010: 330 x 44 x 210 mm (13 x 1.7 x 8.3 in.) SC53020: 440 x 44 x 380 mm (17.3 x 1.7 x 15 in.) SC53030: 440 x 44 x 330 mm (17.3 x 1.7 x 13 in.) SC53040: 440 x 44 x 330 mm (17.3 x 1.7 x 13 in.) SC53050: 440 x 44 x 330 mm (17.3 x 1.7 x 13 in.) SC53060: 440 x 44 x 330 mm (17.3 x 1.7 x 13 in.) SC53070: 440 x 44 x 220 mm (17.3 x 1.7 x 8.7in.) SC53080: 330 x 44 x 210 mm (13 x 1.7 x 8.3 in.) SC53090: 440 x 44 x 330 mm (17.3 x 1.7 x 13 in.)
Weight	SC53010: 2.41 kg (5.32 lb.) SC53020: 6.40 kg (14.12 lb.) SC53030: 5.13 kg (11.31 lb.) SC53040: 3.91 kg (8.61 lb.) SC53050: 4.21 kg (9.28 lb.) SC53060: 4.32 kg (9.53 lb.) SC53070: 2.82 kg (6.22 lb.) SC53080: 2.42 kg (5.34 lb.) SC53090: 4.93 kg (10.86 lb.)
Temperature	Operating: 32 to 122°F (0 to 50°C) Storage: -4 to 158°F (-20 to 70°C)
Humidity	10 to 90% (non-condensing)
Power Specification	
AC Input Power	100-240V~, 50/60Hz
Max Power Consumption	SC53010: 26W SC53020: 1840W SC53030: 920W SC53040: 37W SC53050: 470W SC53060: 30W SC53070: 30W SC53080: 200W SC53090: 940W
Emissions	CE Mark EN 55022, Class A FCC Part 15 Subpart B Class A
Immunity	IEC 61000-3-3, IEC61000-4-2/3/4/5/6/8